



mesa ORMAN
ÇUBUKLU



Green.

The color emerging from the mixture of yellow and blue, seen in the majority of plant leaves.

“Let the sky be blue, branch green, field yellow; let there be land of birds and flowers.”

– C. S. Lewis



Green, the symbol of nature, surrounds Mesa Orman, the neighbour of a rare and treasured forest in Istanbul, with all its shades and inspires the setting of a ravishing living space.

Mesa Orman.
The journey to “Green”
begins.

Located in Çubuklu, Mesa Orman
edges onto the Istanbul City
Forest; one of the most
oxygen-rich places that covers up
to 1.5 million square meters.
Start the day by breathing in the
clean forest air making it
possible for everyone living in the
metropolis to realize their
common dream here.



Original photo of the area.

Inside the forest, yet very close to transport nodes...

In a city like Istanbul which is always lively, you can enjoy the privileged location of Mesa Orman with the ferry service between Çubuklu and İstinye, and with the easy proximity to both bridges, you can choose land access anywhere you desire. This means of dream of keeping up with the dynamic European side while living a tranquil life on the Asian side is now possible.

Location advantages



* Off-peak traffic hours are taken into consideration.





This catalog is for presentation and informational purposes only. The Contractor has the right to make any changes if need be. If there is a contradiction in the size of the houses and the list of places, the application project and the contractual information are considered.



A world at peace with itself; with stunning vibrant surroundings...

The peaceful and active life will continue to be with you when you leave. Fashionable cafés, gourmet restaurants, boutique shops, sports activities and educational facilities are available in the developing areas around Acarlar Neighbourhood, nearby, which enables you and your family to meet all your needs.

In addition, thanks to the proximity of Mesa Orman to the road, the bridges and the Çubuklu - İstinye Ferry, you can go to İstinye Park Shopping Mall anytime you like.





Endless respect for nature...

The Mesa Orman is built without harming the environment despite its location next to the forest. The project sets a best practice example in the region for being the closest yet most respectful to nature.



The healing power of fresh air inside your home...

Mesa Orman's deep bond with green is the antidote for a chaotic city life.

As one of the projects with the highest green space per person in Çubuklu, Mesa Orman's garden floors bring the green to your door and offers a unique environment for you to enjoy the delightful scenery and pleasures of the open air.





**Your nearest neighbor
is a natural lake.**



The word 'nature' is only defined by two colors: Green and Blue.

The inner garden, located right in the middle of the project can be described as a courtyard focal point that, brings Mesa Orman a peaceful and calm atmosphere. Private landscaping brings the greenery and waterways bring the color blue within a mere arm's reach.





**Every place
touched is a part of
nature.**

Bonding with nature



**Lowers cortisol
stress hormones.**

**Increases blood
oxygen levels.**



**Strengthens
immune system.**



**Improves
quality of sleep.**



**Lowers blood
pressure.**

**Increases physical
and mental energy.**

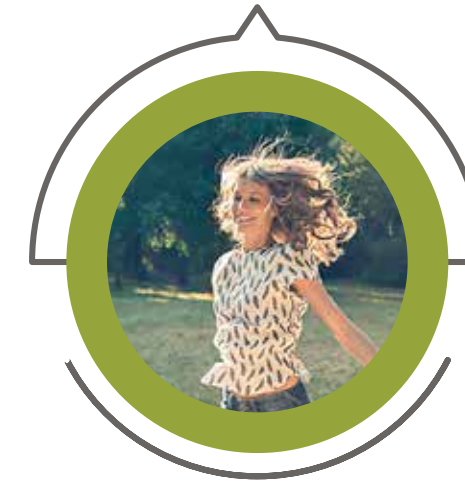

**Improves focus
and creativity.**

**Facilitates
positive
thinking.**







Open the window and listen to the birds chirping.

The courtyard harbors all the colors offered by nature
to detoxify your soul.

To avoid any sound other than rustling leaves and
bird chirps at home, the playground and sports fields are
located in a special area.





Only 219 units. A boutique life and a sustainable future...

Large glass surfaces on the exterior create a sense of eternity within your home, allowing the surrounding nature to fill your home and make the best use of daylight possible.

In Mesa Orman, not only the heating but also the cooling is centrally provided, removing the artificial image of air conditioning units outside the building.

Exterior facades with high insulation reduce carbon emissions. Electricity consumption is also reduced to a minimum, ensuring that the designed living space is compatible with the goal for a sustainable world.

A life where children can live together with nature...

You, your family and your loved ones...

Mesa Orman's high quality can satisfy every need with ease, reflected in the excellence of detail with its parks, gardens, ornamental pools, recreational areas and walking paths, pools, tennis courts and basketball courts.

Mesa Orman offers easy access within the flat terrain where it is located. Kids can run freely and have a great time enjoying the playgrounds and green areas.





A hidden world, a unique jogging track...

Mesa Orman offers a hidden world with its residential buildings located far from traffic and highway noise.

The jogging track that surrounds the project and cuts through its surroundings in a creative way, allowing you to take a morning run in the comfort of clean forest air without going far. this unique track reflects all the beauties of nature, which gives the chance for sports and to take part in social activities with your loved ones, all whilst in a peaceful outdoor environment.



A social life full of options...

Mesa Orman's social facility center will introduce you to unparalleled unique privileges. Have fun with your family, enjoy pleasurable conversations with neighbors, spend leisure time in resting areas or make use of the working areas... No matter what, the social facility center will ensure that every moment you spend here is worthwhile.

You can also host your guests as you wish in the terrace or gardens, read a book in the forest air, do outdoor yoga or simply just enjoy the day.





Playground



Fitness Center



Swimming Pool

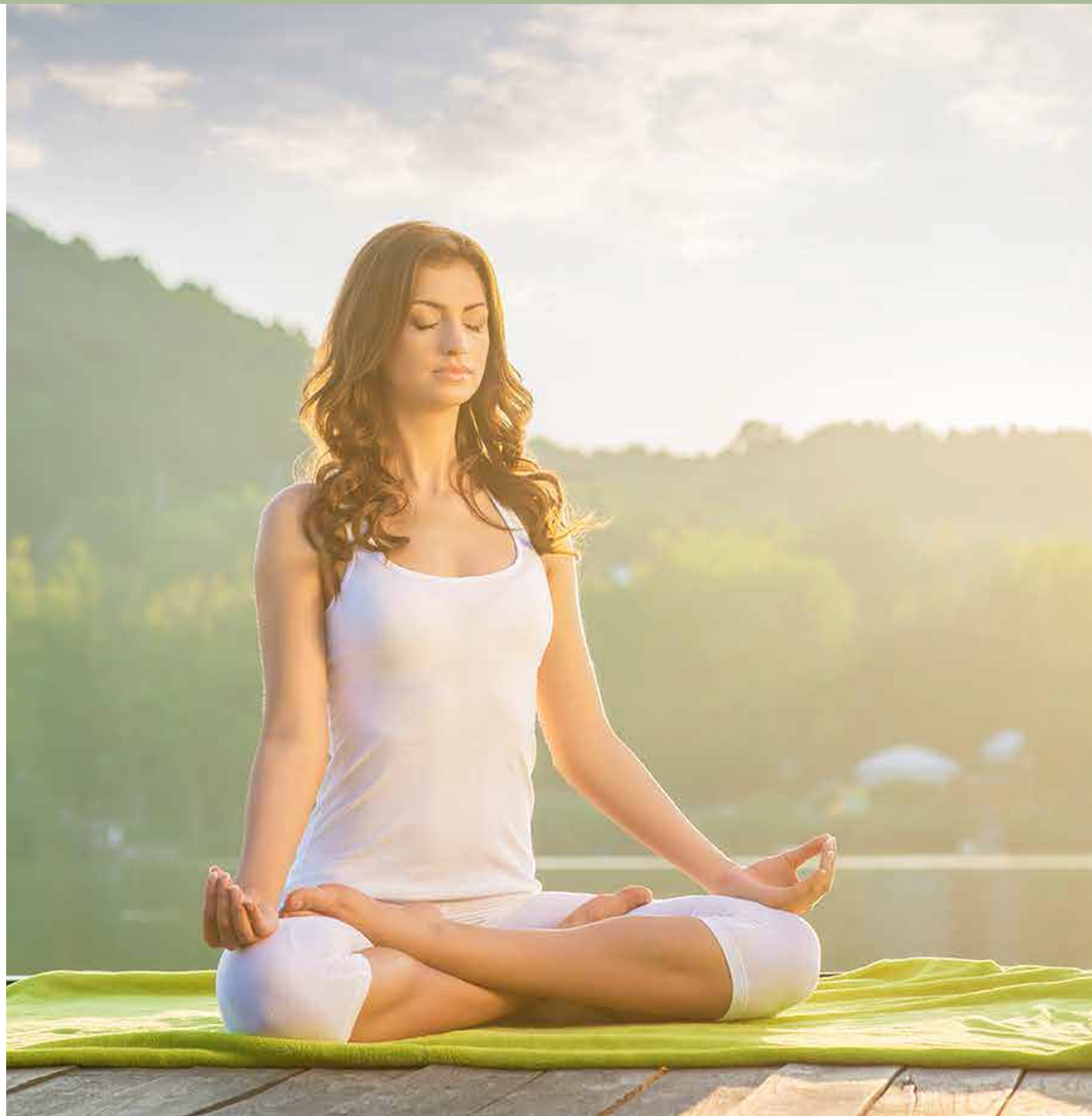



Pleasant with prestigious details...

The Mesa Orman is designed to give maximum comfort within the most optimal area. With an advanced architectural understanding, the most up-to-date, most practical and cleverest usage of space is calculated. By avoiding unconscious consumption of natural resources, a new life formula was created in the center of the city, with the most private living spaces designed for your most valuable asset, your family.

Mesa Orman is designed by putting family life at the center; therefore it mostly consists of 3 + 1 and 4 + 1 apartments that offer spacious living areas between 125-300 m² and enrich with aesthetic details to maximize your living standards.





Who could guess that grace has a color?

Thanks to the natural materials used, the interior spaces integrate with the lush environment and are ideal to rest your soul to get away from the stress of everyday life.

Designed using the most exclusive materials of world famous brands, the living spaces complement the aesthetics of a graceful style.



Orman 1 - location plan

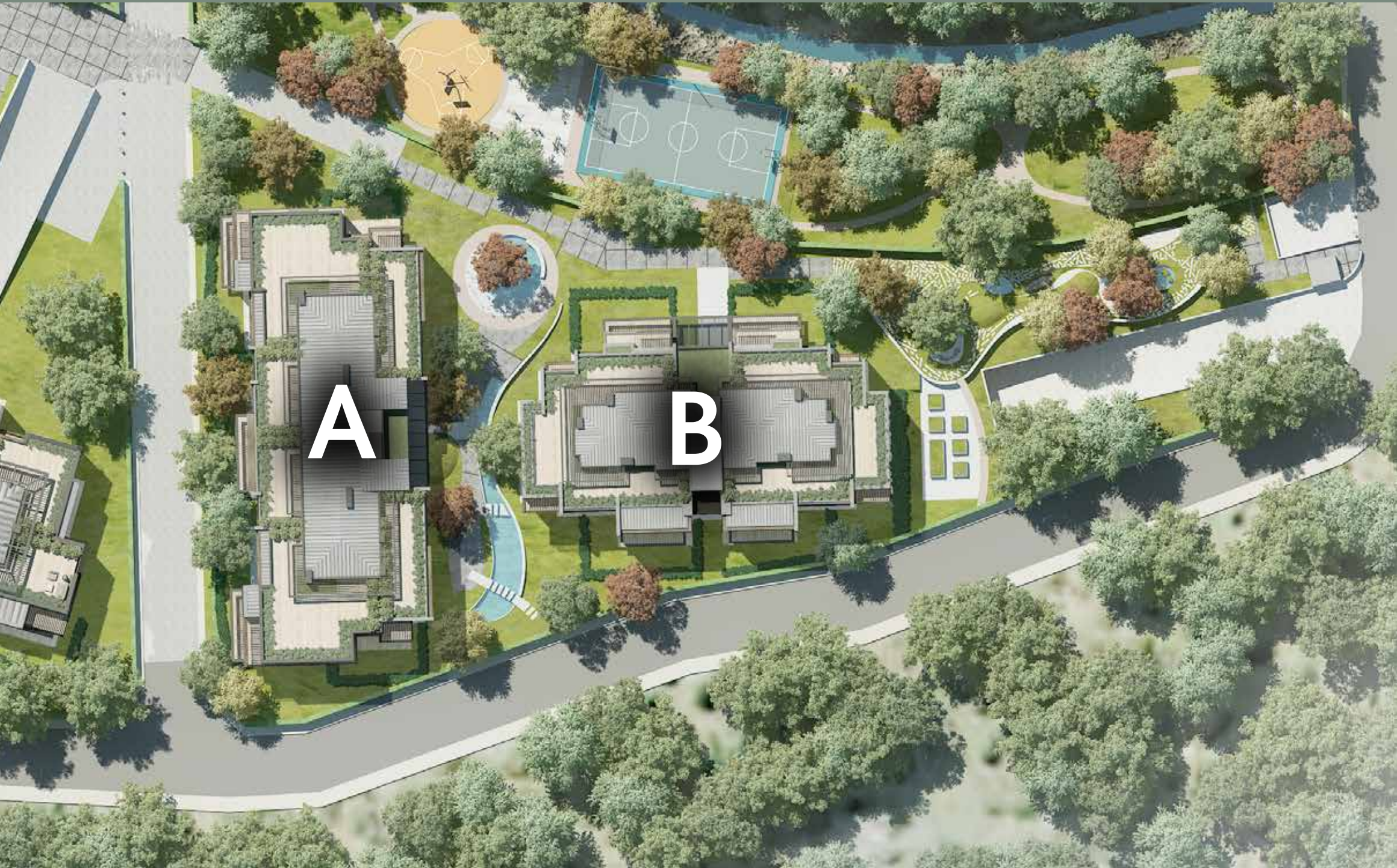

Orman 1
living options

2+1 A - Z
A BLOCK GROUND FLOOR

GROSS AREA : 124.71 m²
NET AREA : 89.42 m²
TOTAL NET AREA : 89.42 m²

LIVING ROOM : 27.85 m²
KITCHEN : 12.31 m²
BATHROOM : 4.31 m²
BEDROOM : 11.11 m²
MASTER BEDROOM : 17.47 m²
MASTER BATHROOM : 4.29 m²
CORRIDOR : 4.60 m²
ENTRANCE HALL : 6.12 m²
STUDY ROOM : 1.36 m²
TERRACE : 8.29 m²

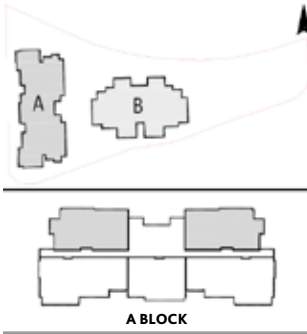

2+1 A
A BLOCK 1st - 2nd - 3rd FLOORS

GROSS AREA : 136.33 m²
NET AREA : 90.72 m²
TOTAL NET AREA : 99.86 m²

LIVING ROOM : 29.15 m²
KITCHEN : 12.31 m²
BATHROOM : 4.31 m²
BEDROOM : 11.11 m²
MASTER BEDROOM : 17.47 m²
MASTER BATHROOM : 4.29 m²
CORRIDOR : 4.60 m²
ENTRANCE HALL : 6.12 m²
STUDY ROOM : 1.36 m²
BALCONY : 6.40 m²
BALCONY : 2.74 m²

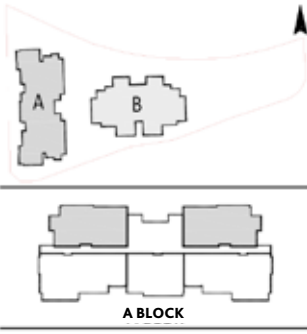

2+1 B - Z
A BLOCK GROUND FLOOR

GROSS AREA : 98.24 m²
NET AREA : 70.16 m²
TOTAL NET AREA : 70.16 m²

LIVING ROOM + KITCHEN : 28.92 m²
BATHROOM : 5.76 m²
BEDROOM : 10.18 m²
MASTER BEDROOM : 15.04 m²
CORRIDOR : 3.62 m²
ENTRANCE HALL : 4.24 m²
STUDY ROOM : 0.73 m²
WC : 1.67 m²
TERRACE : 15.30 m²

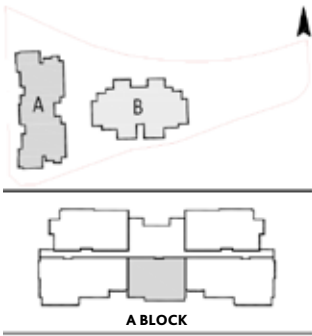

2+1 B
A BLOCK 1st - 2nd - 3rd - 4th FLOORS

GROSS AREA : 109.49 m²
NET AREA : 70.16 m²
TOTAL NET AREA : 79.40 m²

LIVING ROOM + KITCHEN : 28.92 m²
BATHROOM : 5.76 m²
BEDROOM : 10.18 m²
MASTER BEDROOM : 15.04 m²
CORRIDOR : 3.62 m²
ENTRANCE HALL : 4.24 m²
STUDY ROOM : 0.73 m²
WC : 1.67 m²
BALCONY : 9.24 m²

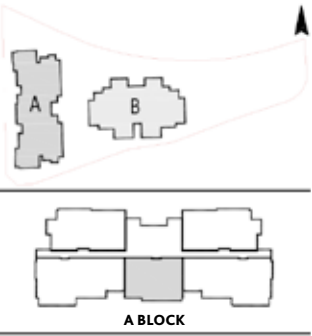

2+1 C - Z
B BLOCK GROUND FLOOR

GROSS AREA : 127.28 m²
NET AREA : 91.83 m²
TOTAL NET AREA : 91.83 m²

LIVING ROOM : 28.99 m²
KITCHEN : 13.02 m²
BATHROOM : 4.60 m²
BEDROOM : 11.17 m²
MASTER BEDROOM : 17.52 m²
MASTER BATHROOM : 4.50 m²
CORRIDOR : 5.02 m²
ENTRANCE HALL : 6.06 m²
STUDY ROOM : 0.95 m²
TERRACE : 13.89 m²

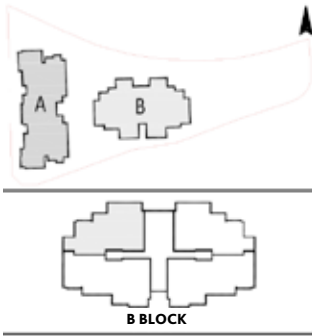

2+1 C
B BLOCK 1st - 2nd - 3rd FLOORS

GROSS AREA : 140.16 m²
NET AREA : 92.24 m²
TOTAL NET AREA : 103.34 m²

LIVING ROOM : 29.39 m²
KITCHEN : 13.01 m²
BATHROOM : 4.60 m²
BEDROOM : 11.17 m²
MASTER BEDROOM : 17.52 m²
MASTER BATHROOM : 4.50 m²
CORRIDOR : 5.02 m²
ENTRANCE HALL : 6.06 m²
STUDY ROOM : 0.97 m²
BALCONY : 9.95 m²
BALCONY : 1.15 m²

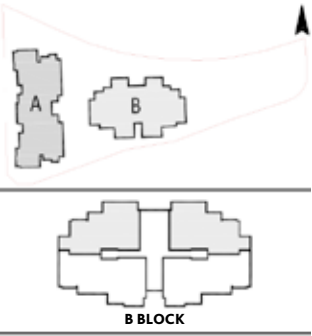

2+1 C1 - Z
B BLOCK GROUND FLOOR

GROSS AREA : 125.43 m²
NET AREA : 90.89 m²
TOTAL NET AREA : 90.89 m²

LIVING ROOM : 29.39 m²
KITCHEN : 11.68 m²
BATHROOM : 4.60 m²
BEDROOM : 11.17 m²
MASTER BEDROOM : 17.52 m²
MASTER BATHROOM : 4.50 m²
CORRIDOR : 5.02 m²
ENTRANCE HALL : 6.06 m²
STUDY ROOM : 0.95 m²
TERRACE : 15.18 m²

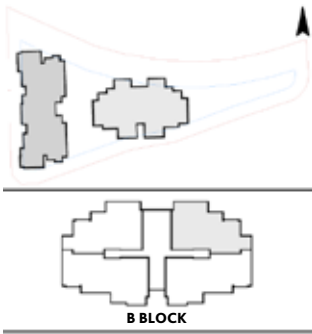

2+1 C1
B BLOCK 4th FLOOR

GROSS AREA : 143.44 m²
NET AREA : 92.24 m²
TOTAL NET AREA : 105.60 m²

LIVING ROOM : 29.39 m²
KITCHEN : 13.01 m²
BATHROOM : 4.60 m²
BEDROOM : 11.17 m²
MASTER BEDROOM : 17.52 m²
MASTER BATHROOM : 4.50 m²
CORRIDOR : 5.02 m²
ENTRANCE HALL : 6.06 m²
STUDY ROOM : 0.97 m²
BALCONY : 10.08 m²
BALCONY : 3.28 m²

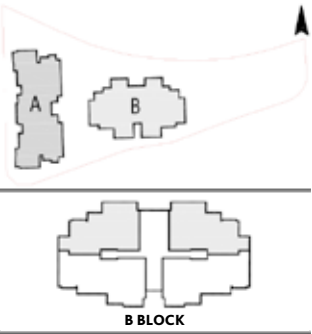

3+1 A - Z
A BLOCK GROUND FLOOR

GROSS AREA : 148.16 m²
NET AREA : 105.89 m²
TOTAL NET AREA : 105.89 m²

LIVING ROOM : 30.93 m²
KITCHEN : 10.35 m²
BATHROOM : 4.57 m²
BEDROOM 1 : 10.86 m²
BEDROOM 2 : 10.02 m²
MASTER BEDROOM : 19.99 m²
MASTER BATHROOM : 4.32 m²
CORRIDOR : 6.79 m²
ENTRANCE HALL : 6.51 m²
STUDY ROOM : 1.55 m²
TERRACE : 13.78 m²

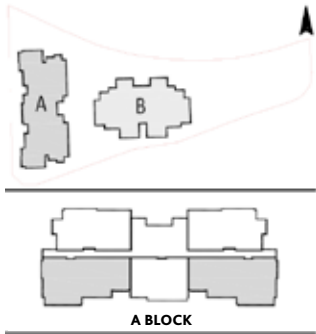

3+1 A
A BLOCK 1st - 2nd - 3rd FLOORS

GROSS AREA : 164.18 m²
NET AREA : 109.34 m²
TOTAL NET AREA : 120.19 m²

LIVING ROOM : 30.93 m²
KITCHEN : 13.80 m²
BATHROOM : 4.57 m²
BEDROOM 1 : 10.86 m²
BEDROOM 2 : 10.02 m²
MASTER BEDROOM : 19.99 m²
MASTER BATHROOM : 4.32 m²
CORRIDOR : 6.79 m²
ENTRANCE HALL : 6.51 m²
STUDY ROOM : 1.55 m²
BALCONY : 8.15 m²
BALCONY : 1.17 m²
BALCONY : 1.53 m²

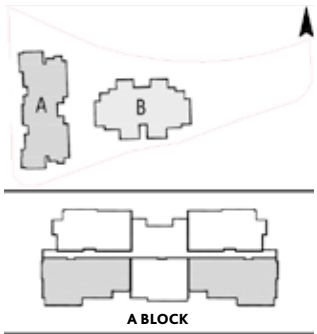

3+1 B - Z
B BLOCK GROUND FLOOR

GROSS AREA : 151.81 m²
NET AREA : 109.81 m²
TOTAL NET AREA : 109.81 m²

LIVING ROOM : 30.51 m²
KITCHEN : 14.62 m²
BATHROOM : 4.60 m²
BEDROOM 1 : 11.07 m²
BEDROOM 2 : 10.11 m²
MASTER BEDROOM : 17.99 m²
MASTER BATHROOM : 4.70 m²
CORRIDOR : 7.93 m²
ENTRANCE HALL : 6.93 m²
STUDY ROOM : 1.35 m²
TERRACE : 11.52 m²

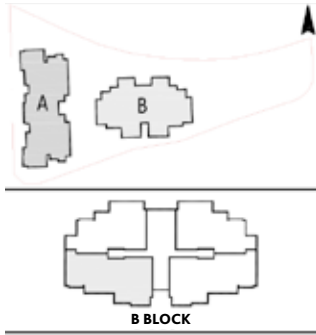

3+1 B
B BLOCK 1st - 2nd - 3rd FLOORS

GROSS AREA : 159.35 m²
NET AREA : 109.79 m²
TOTAL NET AREA : 119.67 m²

LIVING ROOM : 30.51 m²
KITCHEN : 14.62 m²
BATHROOM : 4.60 m²
BEDROOM 1 : 11.07 m²
BEDROOM 2 : 10.10 m²
MASTER BEDROOM : 17.99 m²
MASTER BATHROOM : 4.70 m²
CORRIDOR : 7.92 m²
ENTRANCE HALL : 6.93 m²
STUDY ROOM : 1.35 m²
BALCONY : 8.73 m²
BALCONY : 1.15 m²

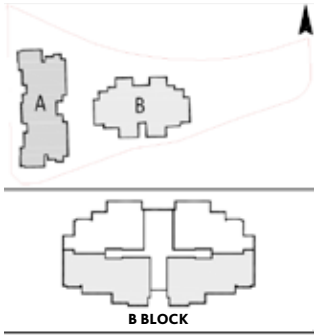

3+1 B1 - Z
B BLOCK GROUND FLOOR

GROSS AREA : 147.66 m²
NET AREA : 106.84 m²
TOTAL NET AREA : 106.84 m²

LIVING ROOM : 30.51 m²
KITCHEN : 11.67 m²
BATHROOM : 4.60 m²
BEDROOM 1 : 11.07 m²
BEDROOM 2 : 10.10 m²
MASTER BEDROOM : 17.99 m²
MASTER BATHROOM : 4.70 m²
CORRIDOR : 7.92 m²
ENTRANCE HALL : 6.93 m²
STUDY ROOM : 1.35 m²
TERRACE : 15.54 m²

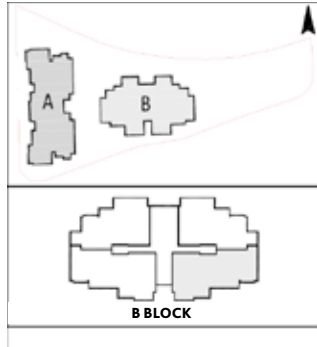

3+1 A1 - T DUPLEX
A BLOCK

GROSS AREA : 188.11 m²
TOTAL NET AREA (WITH BALCONY) : 132.64 m²
TOTAL NET AREA (WITHOUT BALCONY): 123.84 m²

GROUND FLOOR 4th FLOOR

LIVING ROOM : 29.43 m²
KITCHEN : 12.31 m²
BATHROOM : 4.44 m²
BEDROOM 1 : 14.29 m²
BEDROOM 2 : 11.37 m²
CORRIDOR : 5.86 m²
ENTRANCE HALL : 6.33 m²
STUDY ROOM : 3.40 m²
STAIRS : 3.84 m²
BALCONY : 6.08 m²
BALCONY : 2.72 m²

NET AREA (WITH BALCONY) : 100.07 m²
NET AREA (WITHOUT BALCONY): 91.27 m²

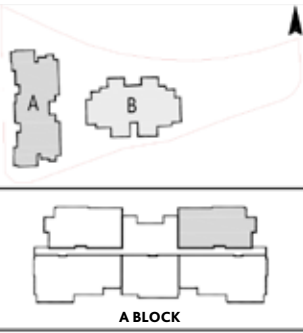

UPPER FLOOR - PENTHOUSE

MASTER BEDROOM : 24.90 m²
MASTER BATHROOM : 4.43 m²
CORRIDOR : 2.99 m²
STAIRS : 0.25 m²
TERRACE : 30.45 m²

NET AREA (WITHOUT TERRACE): 32.57 m²

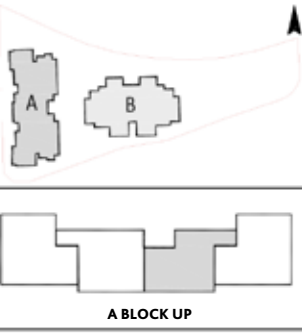

3+1 A2 - T DUPLEX A BLOCK

GROSS AREA : 188.29 m²
TOTAL NET AREA (WITH BALCONY) : 133.27 m²
TOTAL NET AREA (WITHOUT BALCONY): 124.47 m²

GROUND FLOOR 4th FLOOR

LIVING ROOM	: 29.43 m ²
KITCHEN	: 12.31 m ²
BATHROOM	: 4.44 m ²
BEDROOM 1	: 14.29 m ²
BEDROOM 2	: 11.37 m ²
CORRIDOR	: 5.86 m ²
ENTRANCE HALL	: 6.33 m ²
STUDY ROOM	: 3.40 m ²
STAIRS	: 3.84 m ²
BALCONY	: 6.08 m ²
BALCONY	: 2.72 m ²

NET AREA (WITH BALCONY) : 100.07 m²
NET AREA (WITHOUT BALCONY): 91.27 m²

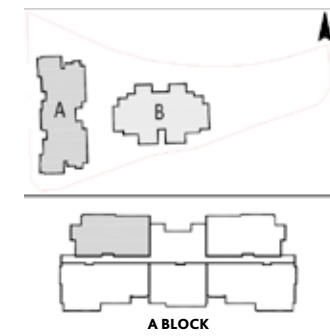

UPPER FLOOR - PENTHOUSE

MASTER BEDROOM	: 25.91 m ²
MASTER BATHROOM	: 4.34 m ²
CORRIDOR	: 2.70 m ²
STAIRS	: 0.25 m ²
TERRACE	: 35.45 m ²

NET AREA (WITHOUT TERRACE): 33.20 m²

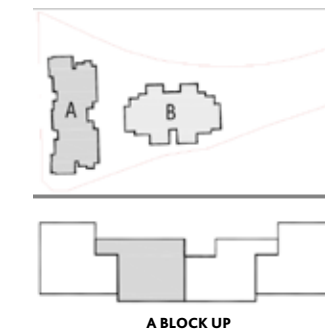

4+1 A1 - T DUPLEX
A BLOCK

GROSS AREA : 236.98 m²
TOTAL NET AREA (WITH BALCONY) : 169.32 m²
TOTAL NET AREA (WITHOUT BALCONY): 160.10 m²

GROUND FLOOR 4th FLOOR

LIVING ROOM	: 37.72 m ²
KITCHEN	: 13.84 m ²
BATHROOM	: 4.26 m ²
BEDROOM 1	: 10.86 m ²
BEDROOM 2	: 10.02 m ²
MASTER BEDROOM	: 16.65 m ²
MASTER BATHROOM	: 4.52 m ²
CORRIDOR	: 11.44 m ²
ENTRANCE HALL	: 6.24 m ²
STUDY ROOM	: 1.37 m ²
STAIRS	: 2.85 m ²
BALCONY	: 1.36 m ²
BALCONY	: 1.17 m ²
BALCONY	: 6.69 m ²

NET AREA (WITH BALCONY) : 128.99 m²
NET AREA (WITHOUT BALCONY): 119.77 m²

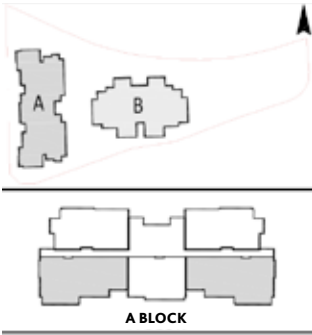

UPPER FLOOR - PENTHOUSE

MASTER BEDROOM	: 24.73 m ²
MASTER BATHROOM	: 5.64 m ²
CORRIDOR	: 6.32 m ²
WC	: 1.79 m ²
STAIRS	: 1.85 m ²
TERRACE	: 86.28 m ²

NET AREA (WITHOUT TERRACE): 40.33 m²

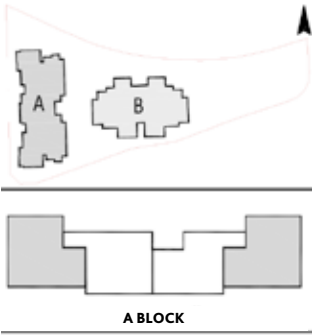

4,5+1 B1 - T DUPLEX
B BLOCK

GROSS AREA : 276.53 m²
TOTAL NET AREA (WITH BALCONY) : 197.94 m²
TOTAL NET AREA (WITHOUT BALCONY): 175.42 m²

GROUND FLOOR 4th FLOOR

- LIVING ROOM : 43.29 m²
- KITCHEN : 16.27 m²
- MASTER BEDROOM : 19.87 m²
- MASTER BATHROOM : 4.97 m²
- CORRIDOR : 7.03 m²
- ENTRANCE HALL : 6.58 m²
- WC : 2.32 m²
- STAIRS : 2.83 m²
- BALCONY : 11.26 m²
- BALCONY : 6.05 m²
- BALCONY : 5.21 m²

NET AREA (WITH BALCONY) : 125.68 m²
NET AREA (WITHOUT BALCONY): 103.16 m²

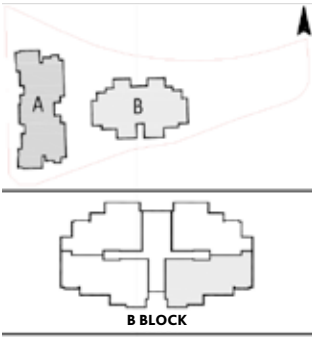

UPPER FLOOR - PENTHOUSE

- BEDROOM 1 : 15.74 m²
- BEDROOM 2 : 12.75 m²
- BEDROOM 3 : 11.86 m²
- BATHROOM : 4.55 m²
- BATHROOM : 3.42 m²
- CORRIDOR : 11.09 m²
- STUDY ROOM : 8.25 m²
- WC : 2.79 m²
- STAIRS : 1.81 m²
- TERRACE : 104.11 m²

NET AREA (WITHOUT TERRACE): 72.26 m²

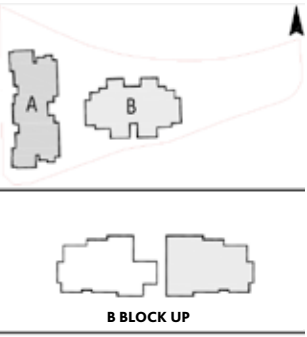

4,5+1 B2 - T DUPLEX
B BLOCK

GROSS AREA : 277.79 m²
TOTAL NET AREA (WITH BALCONY) : 198.90 m²
TOTAL NET AREA (WITHOUT BALCONY): 176.38 m²

GROUND FLOOR 4th FLOOR

LIVING ROOM : 43.29 m²
KITCHEN : 16.27 m²
MASTER BEDROOM : 19.87 m²
MASTER BATHROOM : 4.97 m²
CORRIDOR : 7.03 m²
ENTRANCE HALL : 6.58 m²
WC : 2.32 m²
STAIRS : 2.83 m²
BALCONY : 11.26 m²
BALCONY : 6.05 m²
BALCONY : 5.21 m²

NET AREA (WITH BALCONY) : 125.68 m²
NET AREA (WITHOUT BALCONY): 103.16 m²

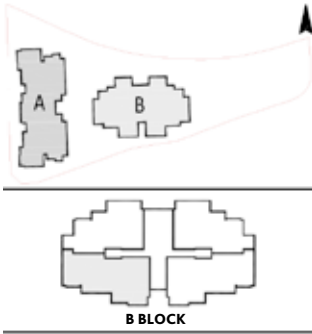

UPPER FLOOR - PENTHOUSE

BEDROOM 1 : 15.39 m²
BEDROOM 2 : 12.36 m²
BEDROOM 3 : 11.86 m²
BATHROOM : 4.55 m²
BATHROOM : 4.70 m²
CORRIDOR : 11.09 m²
STUDY ROOM : 8.67 m²
WC : 2.79 m²
STAIRS : 1.81 m²
TERRACE : 104.29 m²

NET AREA (WITHOUT TERRACE): 73.22 m²

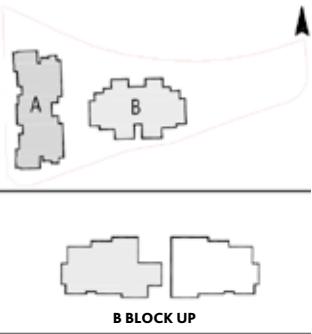

Orman 2 - location plan

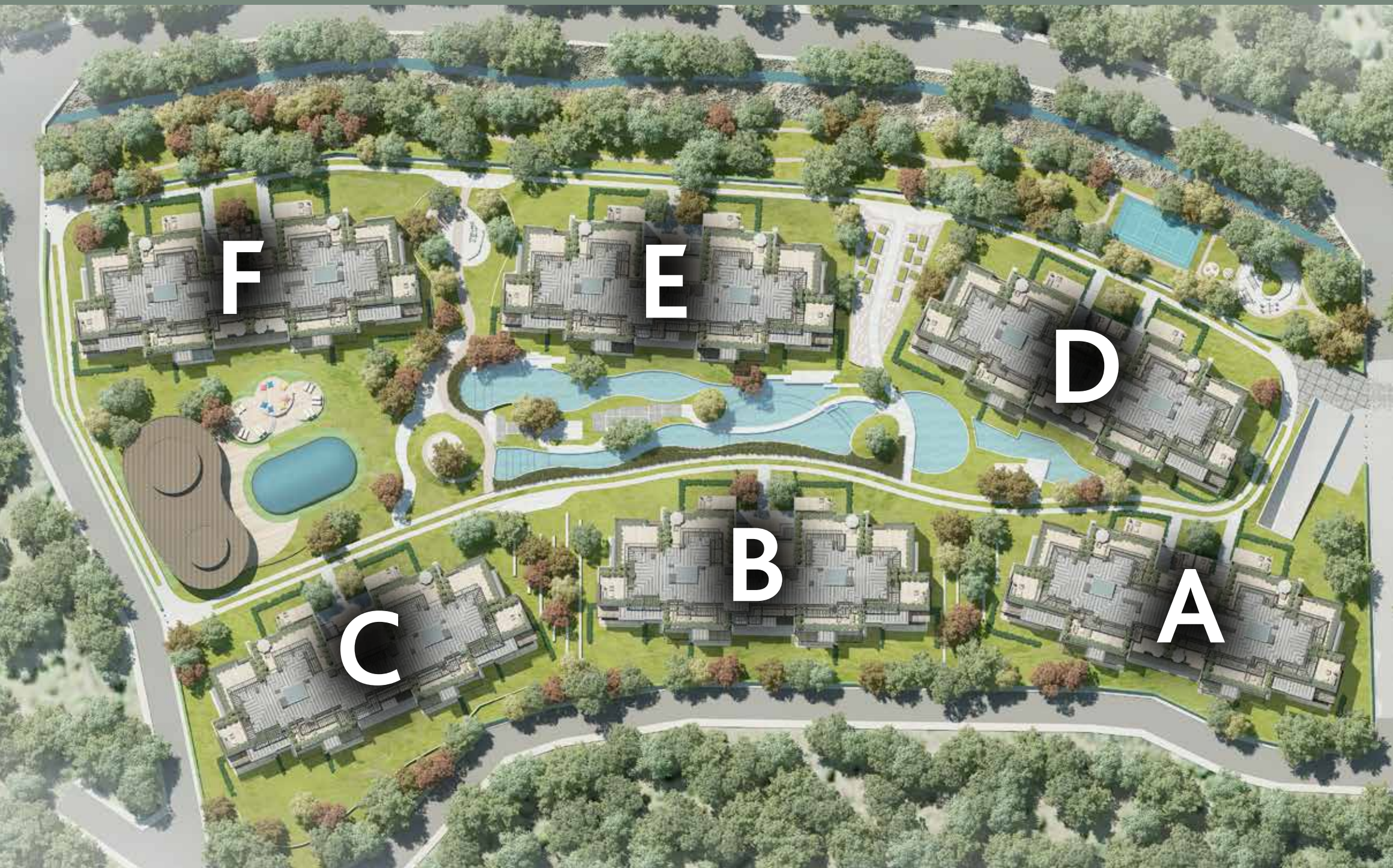

Orman 2
living options

2+1 Z
A-B-C-D-E-F BLOCK GROUND FLOOR

GROSS AREA : 123.52 m²
NET AREA : 95.90 m²
TOPLAM NET : 95.90 m²

LIVING ROOM : 30.29 m²
KITCHEN : 12.30 m²
BATHROOM : 5.70 m²
BEDROOM : 10.22 m²
MASTER BEDROOM : 18.18 m²
MASTER BATHROOM : 5.56 m²
CORRIDOR : 6.02 m²
ENTRANCE HALL : 5.70 m²
STUDY ROOM : 1.93 m²
TERRACE : 21.03 m²

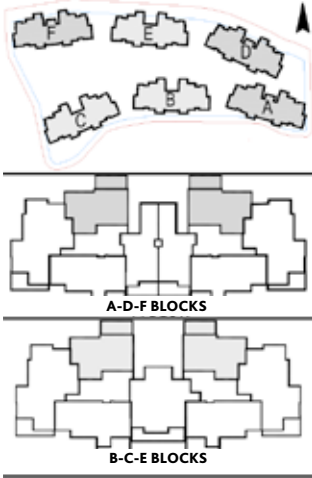

2+1
A-B-C-D-E-F BLOCK 1st - 2nd FLOORS

GROSS AREA : 135.57 m²
NET AREA : 96.83 m²
TOTAL NET AREA : 108.04 m²

LIVING ROOM : 29.31 m²
KITCHEN : 12.30 m²
BATHROOM : 5.70 m²
BEDROOM : 10.22 m²
MASTER BEDROOM : 18.18 m²
MASTER BATHROOM : 5.56 m²
CORRIDOR : 6.02 m²
ENTRANCE HALL : 7.61 m²
STUDY ROOM : 1.93 m²
BALCONY : 11.21 m²

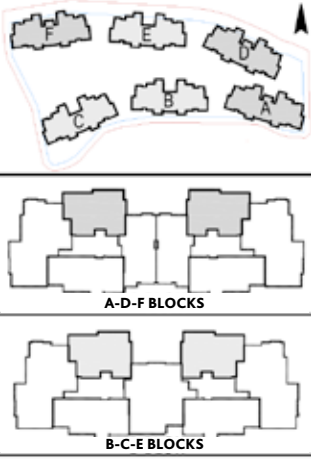

2+1 A
A-D-F BLOCK 2nd FLOOR

GROSS AREA : 124.38 m²
NET AREA : 96.21 m²
TOTAL NET AREA : 98.57 m²

LIVING ROOM : 28.53 m²
KITCHEN : 10.63 m²
BATHROOM : 4.66 m²
BEDROOM : 10.92 m²
MASTER BEDROOM : 18.57 m²
MASTER BATHROOM : 5.28 m²
ENTRANCE HALL : 7.01 m²
CORRIDOR : 3.61 m²
STUDY ROOM : 1.28 m²
CLOSED BALCONY : 5.72 m²
BALCONY : 1.26 m²
BALCONY : 1.10 m²

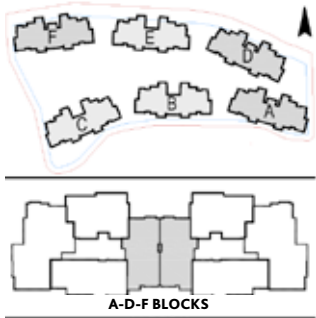

3+1 Z
A-B-C-D-E-F BLOCK GROUND FLOOR

GROSS AREA : 143.36 m²
NET AREA : 112.53 m²
TOTAL NET AREA : 112.53 m²

LIVING ROOM : 31.03 m²
KITCHEN : 10.58 m²
BATHROOM : 4.80 m²
BEDROOM 1 : 11.11 m²
BEDROOM 2 : 10.17 m²
MASTER BEDROOM : 19.25 m²
MASTER BATHROOM : 4.54 m²
ENTRANCE HALL : 6.79 m²
CORRIDOR : 6.90 m²
STUDY ROOM : 1.41 m²
CLOSED BALCONY : 5.95 m²
TERRACE : 15.42 m²

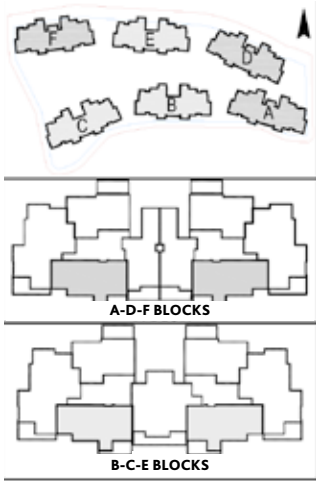

3+1
A-B-C-D-E-F BLOCK 1st - 2nd FLOORS

GROSS AREA : 144.85 m²
NET AREA : 112.48 m²
TOTAL NET AREA : 114.27 m²

LIVING ROOM : 31.03 m²
KITCHEN : 10.58 m²
BATHROOM : 4.80 m²
BEDROOM 1 : 11.11 m²
BEDROOM 2 : 10.17 m²
MASTER BEDROOM : 19.25 m²
MASTER BATHROOM : 4.54 m²
ENTRANCE HALL : 6.76 m²
CORRIDOR : 6.90 m²
STUDY ROOM : 1.39 m²
CLOSED BALCONY : 5.95 m²
BALCONY : 1.79 m²

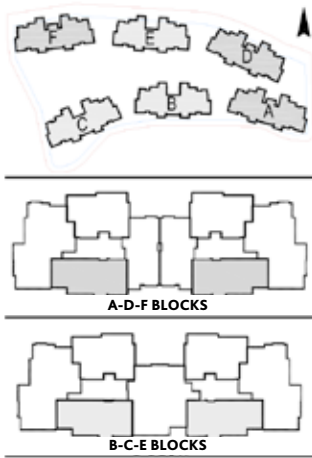

3,5+1 Z
B-C-E BLOCK GROUND FLOOR

GROSS AREA : 173.79 m²
NET AREA : 135.41 m²
TOTAL NET AREA : 135.41 m²

LIVING ROOM : 32.68 m²
KITCHEN : 13.59 m²
BATHROOM : 4.97 m²
BEDROOM 1 : 11.07 m²
BEDROOM 2 : 10.76 m²
MASTER BEDROOM : 25.33 m²
MASTER BATHROOM : 5.44 m²
ENTRANCE HALL : 12.96 m²
CORRIDOR : 7.19 m²
WORK ROOM : 8.61 m²
WC : 2.81 m²
TERRACE : 27.90 m²

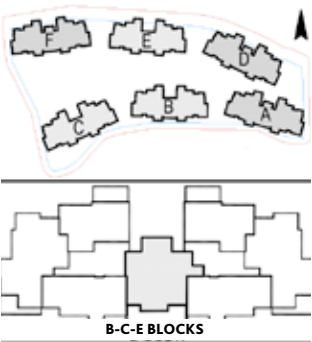

3+1 A - T DUPLEX
A-D-F BLOCK

GROSS AREA : 168.46 m²
TOTAL NET AREA (WITH BALCONY) : 128.65 m²
TOTAL NET AREA (WITHOUT BALCONY): 126.92 m²

GROUND FLOOR 3rd FLOOR

LIVING ROOM : 31.04 m²
KITCHEN : 10.57 m²
BATHROOM : 4.44 m²
BEDROOM 1 : 11.07 m²
BEDROOM 2 : 10.17 m²
ENTRANCE HALL : 6.35 m²
CORRIDOR : 8.02 m²
STUDY ROOM : 1.33 m²
STORAGE : 1.45 m²
STAIRS : 2.90 m²
CLOSED BALCONY : 5.94 m²
BALCONY : 1.73 m²

NET AREA (WITH BALCONY) : 95.01 m²
NET AREA (WITHOUT BALCONY): 93.28 m²

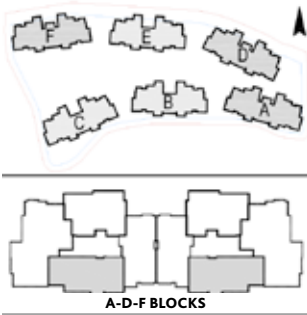

UPPER FLOOR - PENTHOUSE

BEDROOM : 21.11 m²
BATHROOM : 5.33 m²
CORRIDOR : 5.30 m²
STAIRS : 1.90 m²
TERRACE : 57.92 m²

NET AREA (WITHOUT TERRACE): 33.64 m²

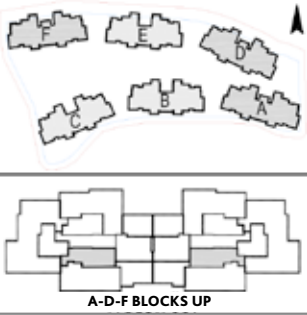

3+1 A1 - T DUPLEX
B-C-E BLOCK

GROSS AREA : 164.01 m²
TOTAL NET AREA (WITH BALCONY) : 125.89 m²
TOTAL NET AREA (WITHOUT BALCONY): 124.16 m²

GROUND FLOOR 3rd FLOOR

LIVING ROOM	: 31.04 m ²
KITCHEN	: 10.57 m ²
BATHROOM	: 4.44 m ²
BEDROOM 1	: 11.07 m ²
BEDROOM 2	: 10.17 m ²
ENTRANCE HALL	: 6.35 m ²
CORRIDOR	: 8.02 m ²
STUDY ROOM	: 1.33 m ²
STORAGE	: 1.45 m ²
STAIRS	: 2.90 m ²
CLOSED BALCONY	: 5.94 m ²
BALCONY	: 1.73 m ²

NET AREA (WITH BALCONY) : 95.01 m²
NET AREA (WITHOUT BALCONY): 93.28 m²

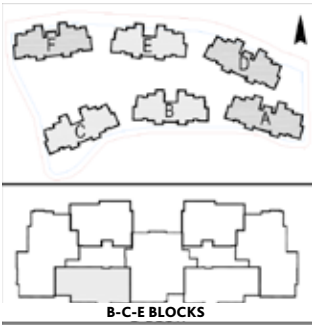

UPPER FLOOR - PENTHOUSE

BEDROOM	: 20.51 m ²
BATHROOM	: 4.67 m ²
CORRIDOR	: 3.81 m ²
STAIRS	: 1.89 m ²
TERRACE	: 58.97 m ²

NET AREA (WITHOUT TERRACE): 30.88 m²

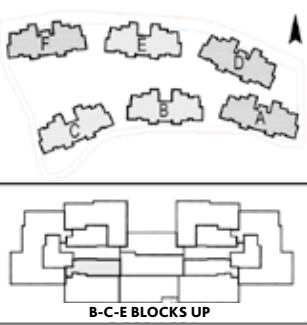

3+1 A2 - T DUPLEX
B-C-E BLOCK

GROSS AREA : 165.94 m²
TOTAL NET AREA (WITH BALCONY) : 126.96 m²
TOTAL NET AREA (WITHOUT BALCONY): 125.23 m²

GROUND FLOOR 3rd FLOOR

LIVING ROOM	: 31.04 m ²
KITCHEN	: 10.57 m ²
BATHROOM	: 4.44 m ²
BEDROOM 1	: 11.07 m ²
BEDROOM 2	: 10.17 m ²
ENTRANCE HALL	: 6.35 m ²
CORRIDOR	: 8.02 m ²
STUDY ROOM	: 1.33 m ²
STORAGE	: 1.45 m ²
STAIRS	: 2.90m ²
CLOSED BALCONY	: 5.94 m ²
BALCONY	: 1.73 m ²

NET AREA (WITH BALCONY) : 95.01 m²
NET AREA (WITHOUT BALCONY): 93.28 m²

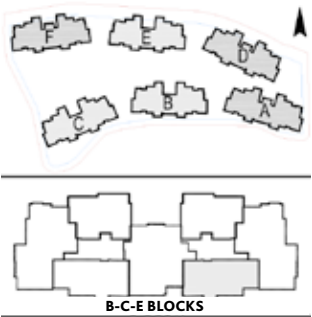

UPPER FLOOR - PENTHOUSE

BEDROOM	: 22.03 m ²
BATHROOM	: 4.23 m ²
CORRIDOR	: 3.82 m ²
STAIRS	: 1.87 m ²
TERRACE	: 61.29 m ²

NET AREA (WITHOUT TERRACE): 31.95 m²

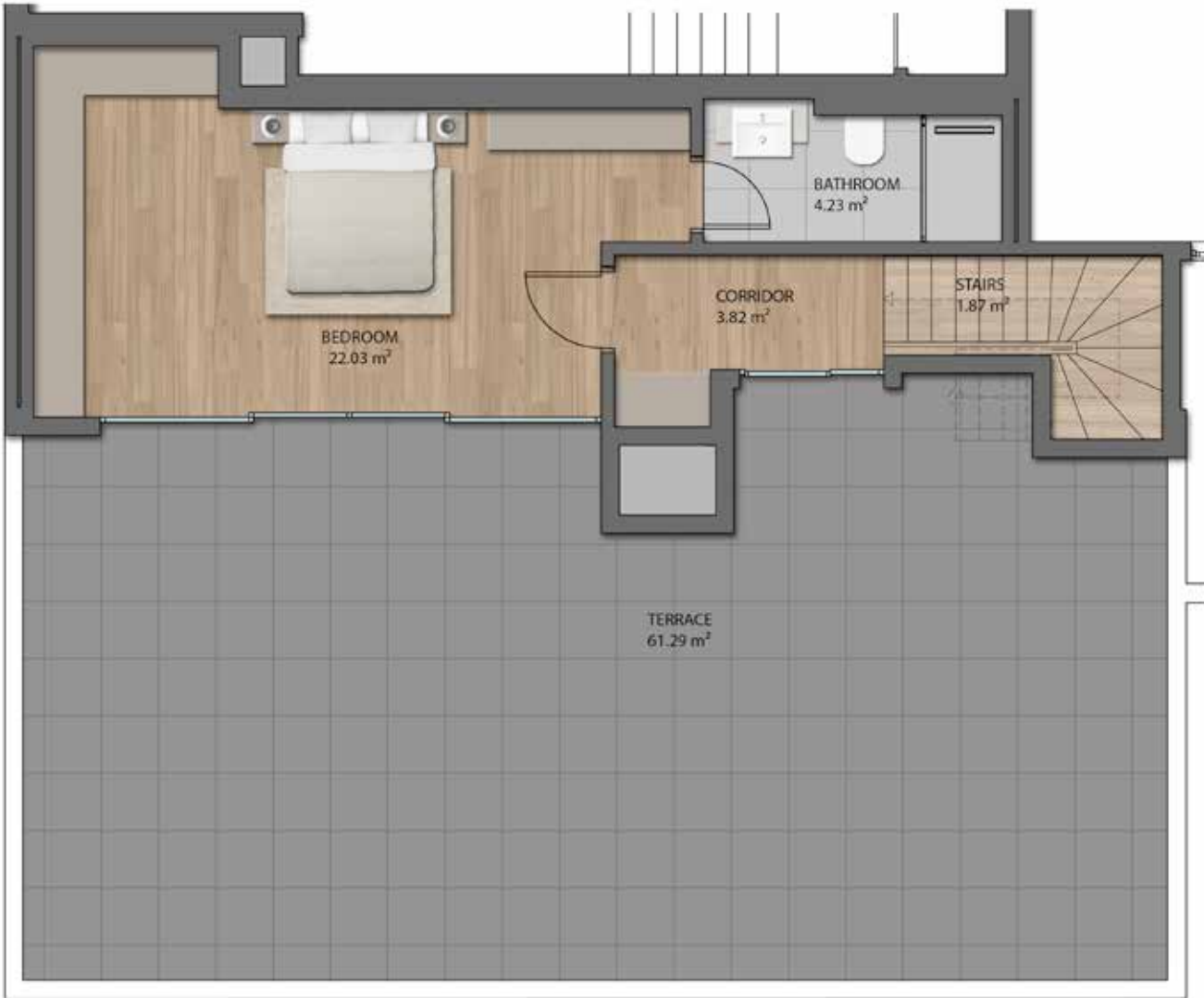
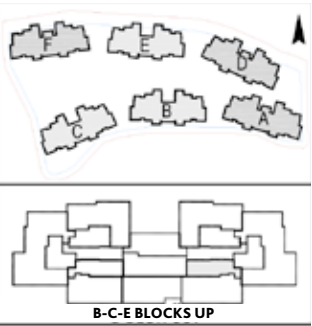

3+1 B - T DUPLEX
A-B-C-D-E-F BLOCK

GROSS AREA : 176.91 m²
TOTAL NET AREA (WITH BALCONY) : 133.45 m²
TOTAL NET AREA (WITHOUT BALCONY): 122.53 m²

GROUND FLOOR 3rd FLOOR

LIVING ROOM : 29.38 m²
KITCHEN : 12.30 m²
BATHROOM : 4.25 m²
BEDROOM : 9.99 m²
MASTER BEDROOM : 18.18 m²
MASTER BATHROOM : 5.43 m²
ENTRANCE HALL : 8.04 m²
CORRIDOR : 4.72 m²
STUDY ROOM : 0.96 m²
STAIRS : 4.20 m²
BALCONY : 10.92 m²

NET AREA (WITH BALCONY) : 108.37 m²
NET AREA (WITHOUT BALCONY): 97.45 m²

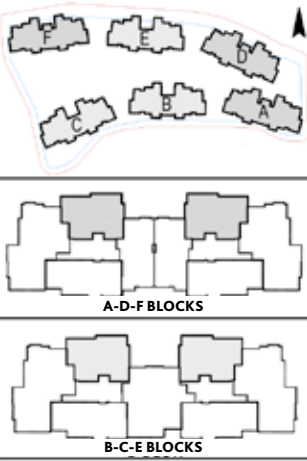

UPPER FLOOR - PENTHOUSE

BEDROOM : 15.45 m²
BATHROOM : 5.25 m²
CORRIDOR : 3.58 m²
STAIRS : 0.80 m²
TERRACE : 73.16 m²

NET AREA (WITHOUT TERRACE): 25.08 m²

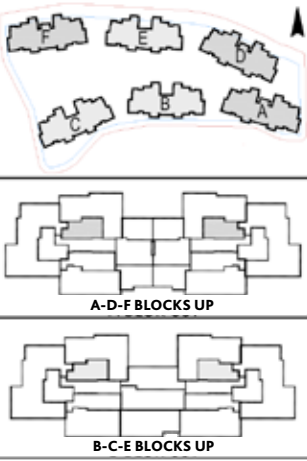

3 +1 C - T DUPLEX
A-D-F BLOCK

GROSS AREA : 174.88 m²
TOTAL NET AREA (WITH BALCONY) : 133.59 m²
TOTAL NET AREA (WITHOUT BALCONY): 131.23 m²

GROUND FLOOR 3rd FLOOR

LIVING ROOM	: 31.16 m ²
KITCHEN	: 10.63 m ²
BATHROOM	: 5.45 m ²
BEDROOM 1	: 13.37 m ²
BEDROOM 2	: 11.23 m ²
ENTRANCE HALL	: 6.90 m ²
CORRIDOR	: 6.97 m ²
STUDY ROOM	: 1.62 m ²
STAIRS	: 3.38 m ²
CLOSED BALCONY	: 5.73 m ²
BALCONY	: 1.26 m ²
BALCONY	: 1.10 m ²

NET AREA (WITH BALCONY) : 98.80 m²
NET AREA (WITHOUT BALCONY): 96.44 m²

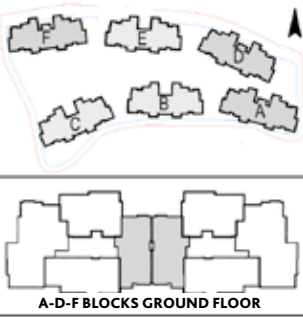

UPPER FLOOR - PENTHOUSE

MASTER BEDROOM	: 17.32 m ²
MASTER BATHROOM	: 4.70 m ²
CORRIDOR	: 6.62 m ²
DRESSING ROOM	: 4.57 m ²
STAIRS	: 1.58 m ²
TERRACE	: 30.60 m ²
TERRACE	: 21.64 m ²

NET AREA (WITHOUT TERRACE): 34.79 m²

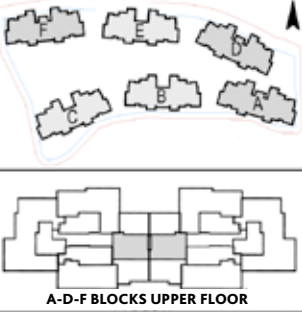

4+1 Z
A-B-C-D-E-F BLOCK GROUND FLOOR

GROSS AREA : 190.19 m²
NET AREA : 149.30 m²
TOTAL NET AREA : 149.30 m²

LIVING ROOM	: 39.79 m ²
KITCHEN	: 18.16 m ²
BATHROOM	: 5.15 m ²
BEDROOM 1	: 13.27 m ²
BEDROOM 2	: 11.11 m ²
BEDROOM 3	: 11.11 m ²
MASTER BEDROOM	: 21.50 m ²
MASTER BATHROOM	: 7.30 m ²
ENTRANCE HALL	: 9.17 m ²
CORRIDOR	: 8.53 m ²
STUDY ROOM	: 1.75 m ²
WC	: 2.46 m ²
TERRACE	: 19.77 m ²

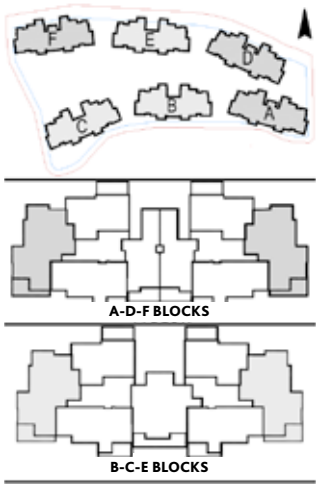

4+1
A-B-C-D-E-F BLOCK 1st - 2nd FLOORS

GROSS AREA : 204.43 m²
NET AREA : 149.30 m²
TOTAL NET AREA : 162.38 m²

LIVING ROOM	: 39.79 m ²
KITCHEN	: 18.16 m ²
BATHROOM	: 5.15 m ²
BEDROOM 1	: 13.27 m ²
BEDROOM 2	: 11.11 m ²
BEDROOM 3	: 11.11 m ²
MASTER BEDROOM	: 21.50 m ²
MASTER BATHROOM	: 7.30 m ²
ENTRANCE HALL	: 9.17 m ²
CORRIDOR	: 8.53 m ²
STUDY ROOM	: 1.75 m ²
WC	: 2.46 m ²
BALCONY	: 11.31 m ²
BALCONY	: 1.04 m ²
BALCONY	: 0.73 m ²

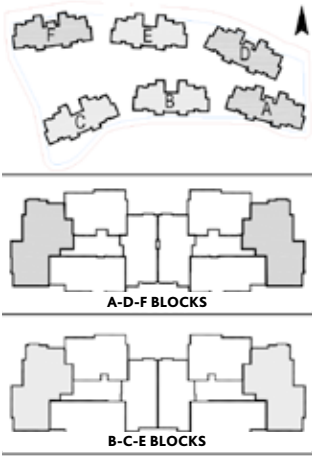

4+1 B
B-C-E BLOCK 1st - 2nd FLOORS

GROSS AREA : 210.87 m²
NET AREA : 149.54 m²
TOTAL NET AREA : 163.98 m²

LIVING ROOM	: 36.67 m ²
KITCHEN	: 13.57 m ²
BATHROOM	: 4.97 m ²
BEDROOM 1	: 13.18 m ²
BEDROOM 2	: 13.55 m ²
BEDROOM 3	: 10.93 m ²
MASTER BEDROOM	: 25.32 m ²
MASTER BATHROOM	: 5.44 m ²
ENTRANCE HALL	: 11.96 m ²
CORRIDOR	: 7.10 m ²
STUDY ROOM	: 2.37 m ²
CLOAKROOM	: 1.95 m ²
WC	: 2.53 m ²
BALCONY	: 7.31 m ²
BALCONY	: 5.96 m ²
BALCONY	: 1.17 m ²

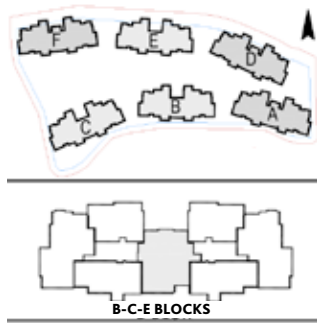

4+1 D DUPLEX
A-D-F BLOCK

GROSS AREA : 227.57 m²
TOTAL NET AREA (WITH BALCONY) : 178.32 m²
TOTAL NET AREA (WITHOUT BALCONY): 177.22 m²

GROUND FLOOR GROUND FLOOR

LIVING ROOM	: 40.65 m ²
KITCHEN	: 18.73 m ²
ENTRANCE HALL	: 8.76 m ²
CORRIDOR	: 3.63 m ²
STUDY ROOM	: 2.44 m ²
CELLAR	: 4.41 m ²
WC	: 3.12 m ²
STAIRS	: 2.84 m ²
TERRACE	: 17.83 m ²

NET AREA (WITHOUT TERRACE): 84.58 m²

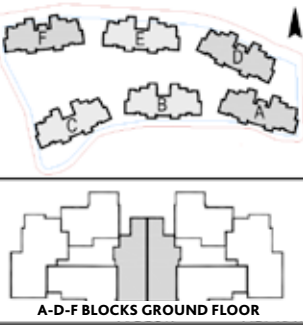

UPPER FLOOR - 1st FLOOR

BEDROOM 1	: 16.89 m ²
BEDROOM 2	: 15.59 m ²
BEDROOM 3	: 11.65 m ²
MASTER BEDROOM	: 21.40 m ²
MASTER BATHROOM	: 5.39 m ²
BATHROOM	: 4.47 m ²
BATHROOM	: 3.96 m ²
CORRIDOR	: 6.46 m ²
STUDY ROOM	: 4.01 m ²
STAIRS	: 2.82 m ²
BALCONY	: 1.10 m ²

NET AREA (WITH BALCONY) : 93.74 m²
NET AREA (WITHOUT BALCONY): 92.64 m²

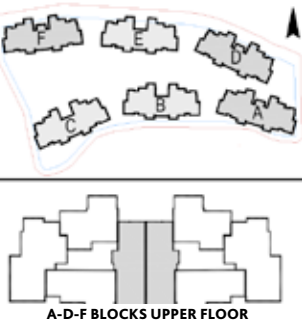

5,5+1 DUPLEX
B-C-E BLOCK

GROSS AREA : 292.54 m²
TOTAL NET AREA (WITH BALCONY) : 227.88 m²
TOTAL NET AREA (WITHOUT BALCONY): 214.16 m²

GROUND FLOOR 3rd FLOOR

- LIVING ROOM : 46.21 m²
- KITCHEN : 16.06 m²
- BATHROOM : 4.57 m²
- BATHROOM : 4.38 m²
- BEDROOM 1 : 15.61 m²
- BEDROOM 2 : 11.14 m²
- MASTER BEDROOM : 19.45 m²
- MASTER BATHROOM : 3.48 m²
- ENTRANCE HALL : 13.92 m²
- CORRIDOR : 7.23 m²
- STUDY ROOM : 7.54 m²
- WC : 2.51 m²
- STAIRS : 0.53 m²
- BALCONY : 8.12 m²
- BALCONY : 3.79 m²
- BALCONY : 0.92 m²
- BALCONY : 0.89 m²

NET AREA (WITH BALCONY) : 166.35 m²
NET AREA (WITHOUT BALCONY): 152.63 m²

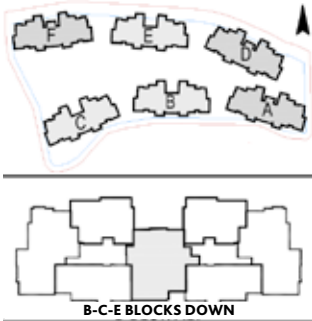

UPPER FLOOR - PENTHOUSE

- LIVING ROOM : 20.04 m²
- MASTER BEDROOM : 21.91 m²
- MASTER BATHROOM : 5.24 m²
- DRESSING ROOM : 6.79 m²
- CORRIDOR : 3.27 m²
- STAIRS : 4.28 m²
- TERRACE : 45.31 m²
- TERRACE : 40.76 m²

NET AREA (WITHOUT TERRACE): 61.53 m²

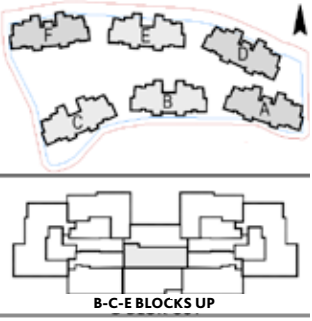

6+1 T DUPLEX
A-B-C-D-E-F BLOCK

GROSS AREA : 274.98 m²
TOTAL NET AREA (WITH BALCONY) : 213.97 m²
TOTAL NET AREA (WITHOUT BALCONY): 197.63 m²

GROUND FLOOR 3rd FLOOR

LIVING ROOM : 40.20 m²
KITCHEN : 18.29 m²
BATHROOM : 5.15 m²
BEDROOM 1 : 13.27 m²
BEDROOM 2 : 11.11 m²
BEDROOM 3 : 11.11 m²
MASTER BEDROOM : 20.74 m²
MASTER BATHROOM : 4.42 m²
ENTRANCE HALL : 10.92 m²
CORRIDOR : 9.36 m²
STUDY ROOM : 2.38 m²
LIVING ROOM : 16.86 m²
STAIRS : 3.88 m²
WC : 3.10 m²
BALCONY : 12.33 m²
BALCONY : 3.28 m²
BALCONY : 0.73 m²

NET AREA (WITH BALCONY) : 187.13 m²
NET AREA (WITHOUT BALCONY): 170.79 m²

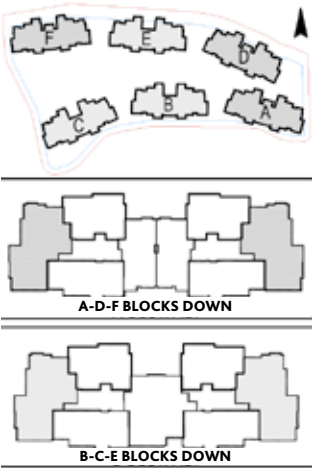

UPPER FLOOR - PENTHOUSE

BEDROOM : 16.83 m²
BATHROOM : 5.15 m²
CORRIDOR : 4.31 m²
STAIRS : 0.55 m²
TERRACE : 57.53 m²

NET AREA (WITHOUT TERRACE): 26.84 m²

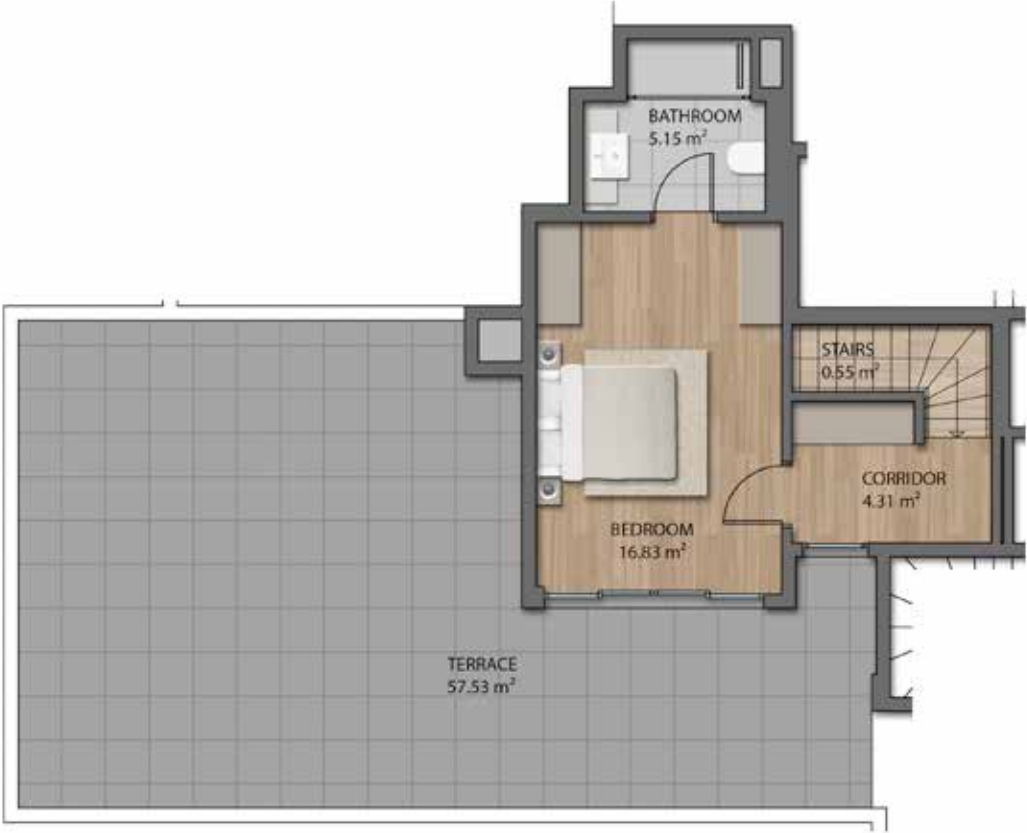
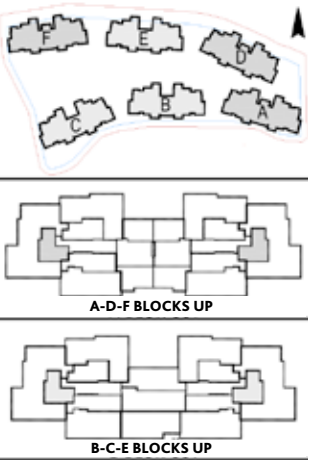



In 1969 Mesa, then named as Mesa Mesken Sanayii, started its journey to add value to lives and be the **“trailblazer”** in the industry. Through bold and innovative steps, Mesa continues to soar upon the shoulders of hundreds of thousands of satisfied customers who have placed trust in the Mesa brand in almost every single area it operates. Creating designs that take into account a holistic approach towards house construction, Mesa has introduced the **“Branded Housing”** concept, setting new standards and changing perceptions of housing estates.

Mesa is involved in every production stage including its infrastructure works and landscaping from the initial design stage to its delivery and after delivery services. Mesa has built and settled more than 100.000 houses on 12,000,000 square meters to date. All Mesa products are hallmarks of the company’s unique quality based vision. With a workforce of nearly 4,500 qualified employees strengthening the company’s core, Mesa affirms it’s stature as a strong corporate entity entrusted by all.

Mesa has become a trusted “Life Brand” by continuously expanding into new areas of investment that goes beyond its original mission as a provider of branded housing. By combining entrepreneurship with contractorship and manufacturing, Mesa carries out its outstanding award recognized performance. In addition to providing superior housing complexes with

their solid infrastructure, technical and social facilities and finely executed landscape plans we are also building business centers, shopping malls, schools, hospitals, tourism and sports facilities, city parks, health and cultural centers, office buildings, industrial facilities and lots of other similar superstructures both locally and abroad. While Mesa organizations undertake design, planning and construction works to ensure the safe progress of building projects, the company also manufactures building components for the construction industry such as steel formwork, steel meshes, woodwork and joinery, precast materials and especially tunnel formwork, steaming ahead to global leadership and ensuring exceptional quality of workmanship.

Mesa is proud to give an “Unconditional Customer Satisfaction Guarantee” for every building and operates a “Customer Service Department” that brings a new dimension to quality service through prompt interventions in case of unforeseen complaints that may occur. Like some of its innovations it has brought to the mass housing sector such as “Steel Tunnel Formwork Technology”, “Customer Service Department” and “Housing Estate Maintenance Service” which are all **“firsts”** in the industry, Mesa is stepping into other sectors with greater confidence, taking pride in designing the next 50 years of Mesa based on its strong and well recognized principles and values.



mesa ORMAN
ÇUBUKLU

mesaorman.com | 444 9 366

Acarlar Mah. Çubuklu Çiftlikyolu Cad. No: 2, 34805 Beykoz - İstanbul T +90 216 680 81 50

